



TUBI

Tubi saldati tondi da nastro laminati a caldo neri e decapati

| Diametro mm | Spessore | | | | | | |
|----------------|----------|------|-------|-------|-------|-------|--------|
| | 1,5 | 2 | 3 | 4 | 5 | 6 | 8 |
| 10 | 0,32 | | | | | | |
| 12 | 0,37 | | | | | | |
| 14 | 0,49 | | | | | | |
| 15 | 0,59 | | | | | | |
| 16 | 0,54 | 0,69 | | | | | |
| 18 | 0,61 | 0,79 | | | | | |
| 20 | 0,68 | 0,89 | | | | | |
| 22 | 0,76 | 0,99 | | | | | |
| 25 | 0,87 | 1,13 | 1,63 | | | | |
| 28 | 0,98 | 1,28 | 1,65 | | | | |
| 30 | 1,05 | 1,38 | 2,00 | | | | |
| 32 | 1,13 | 1,48 | 2,15 | | | | |
| 33 | 1,18 | 1,55 | 2,25 | 2,91 | | | |
| 35 | 1,24 | 1,63 | 2,37 | | | | |
| 38 | 1,35 | 1,78 | 2,59 | 3,38 | | | |
| 40 | 1,42 | 1,88 | 2,74 | 3,55 | | | |
| 42 | 1,50 | 1,97 | 2,89 | 3,75 | | | |
| 45 | 1,61 | 2,12 | 3,11 | 4,05 | | | |
| 48 | 1,72 | 2,27 | 3,33 | 4,38 | 5,22 | | |
| 50 | 1,79 | 2,37 | 3,48 | 4,54 | | | |
| 55 | 1,98 | 2,61 | 3,85 | 5,03 | | | |
| 57 | 2,05 | 2,71 | 4,00 | 5,23 | | | |
| 60 | 2,16 | 2,86 | 4,22 | 5,52 | 6,61 | | |
| 63 | 2,27 | 3,01 | 4,40 | 5,70 | | | |
| 65 | 2,35 | 3,11 | 4,59 | 6,02 | | | |
| 70 | 2,53 | 3,35 | 4,96 | 6,51 | 8,02 | | |
| 76 | 2,76 | 3,65 | 5,40 | 7,10 | 8,76 | | |
| 80 | 2,90 | 3,85 | 5,70 | 7,50 | 9,26 | | |
| 89 | | 5,33 | 8,38 | 10,36 | 12,29 | 14,17 | |
| 102 | | 6,13 | 9,67 | 11,96 | 14,37 | 16,41 | |
| 108 | | | 10,26 | 12,70 | 15,09 | 17,44 | |
| 114,3 | | | 10,85 | 13,44 | 15,99 | 18,49 | |
| 121 | | | 11,45 | 14,31 | 17,02 | 19,69 | |
| 127 | | | 12,13 | 15,04 | 17,90 | 20,74 | |
| 133 | | | 12,73 | 15,78 | 18,79 | 21,77 | |
| 139,7 | | | 13,39 | 16,61 | 19,78 | 22,93 | |
| 152 | | | 14,60 | 18,13 | 21,60 | 25,00 | |
| 159 | | | 15,29 | 18,99 | 22,64 | 26,24 | |
| 168,3 | | | 16,18 | 20,10 | 23,97 | 27,79 | 31,64 |
| 193,7 | | | 18,55 | 23,06 | 27,52 | 31,94 | 36,66 |
| 219 | | | 21,21 | 26,39 | 31,06 | 36,59 | 41,67 |
| 244,5 | | | 23,75 | 29,57 | 35,33 | 41,05 | 46,69 |
| 273 | | | 26,54 | 33,05 | 39,55 | 45,97 | 52,31 |
| 323,9 | | | 31,56 | 39,32 | 46,30 | 54,70 | 62,36 |
| 339,7 | | | 33,15 | 41,32 | 49,44 | 57,50 | |
| 355,6 | | | 34,72 | 43,28 | 51,79 | 60,25 | 68,62 |
| 406,4 | | | 39,74 | 49,55 | 59,32 | 69,03 | 78,65 |
| 457,2 | | | | 55,83 | 66,84 | 77,81 | 93,00 |
| 508 | | | | 62,10 | 74,37 | 86,59 | 103,00 |

TUBI

Tubi tondi serie speciale



| Diametro mm | Spessore | | |
|-------------|----------|-------|-------|
| | 1,5 | 2 | 3 |
| 100 | 3,67 | 4,90 | 7,35 |
| 120 | 4,41 | 5,88 | 8,82 |
| 150 | 5,51 | 7,35 | 11,02 |
| 180 | 6,61 | 8,82 | 13,23 |
| 200 | 7,35 | 9,80 | 14,70 |
| 220 | 8,08 | 10,78 | 16,16 |
| 250 | 9,08 | 12,90 | 18,15 |
| 300 | 11,00 | 15,20 | 21,78 |



tubi

Tubi tondi carpenteria

Neri, zincati, zincati vite e manicotto

| Diametro Pollici | Diametro mm | Spessore mm | Peso neri Kg/m | Peso Zincati Kg/m |
|------------------|-------------|-------------|----------------|-------------------|
| 3/8" | 16,75 | 2,00 | 0,74 | 0,81 |
| 1/2" | 21,25 | 2,30 | 0,95 | 1,18 |
| 3/4" | 26,75 | 2,50 | 1,41 | 1,51 |
| 1" | 33,48 | 2,50 | 2,01 | 2,12 |
| 1 1/4" | 42,25 | 2,50 | 2,58 | 2,71 |
| 1 1/2" | 48,25 | 3,00 | 3,37 | 3,32 |
| 2" | 60,00 | 3,00 | 4,22 | 4,28 |
| 2 1/2" | 76,00 | 3,00 | 5,40 | 6,04 |
| 3" | 88,90 | 3,00 | 6,36 | 7,14 |
| 3 1/2" | 101,60 | 3,00 | 7,32 | 9,10 |
| 4" | 114,30 | 3,00 | 8,21 | 10,30 |
| 4 1/2" | 127,00 | 4,00 | 12,20 | |
| 5" | 139,70 | 4,00 | 13,50 | |
| 5 1/2" | 152,00 | 4,50 | 16,36 | |
| 6" | 168,00 | 4,50 | 18,20 | |
| 8" | 219,00 | 4,50 | 23,70 | |



TUBI

**Tubi tondi laminati a caldo
Neri provati fino a 50 ATM.**

| Diametro Pollici | Diametro mm | Spessore mm | Peso Kg/m |
|------------------|-------------|-------------|-----------|
| 1/8" | 10,00 | 1,80 | 0,372 |
| 1/4" | 13,25 | 2,00 | 0,577 |
| 3/8" | 16,75 | 2,00 | 0,753 |
| 1/2" | 21,25 | 2,35 | 1,110 |
| 3/4" | 26,75 | 2,35 | 1,420 |
| 1" | 33,48 | 2,90 | 2,230 |
| 1 1/4" | 42,25 | 2,90 | 2,870 |
| 1 1/2" | 48,25 | 2,90 | 3,300 |
| 2" | 60,00 | 3,25 | 4,630 |
| 2 1/4" | 76,00 | 3,25 | 5,930 |
| 3" | 89,00 | 3,65 | 7,820 |
| 3 1/4" | 102,00 | 3,65 | 8,950 |
| 4" | 114,30 | 4,05 | 11,300 |
| 5" | 139,07 | 4,85 | 16,700 |
| 6" | 168,00 | 4,85 | 19,800 |



TUBI

Tubi tondi grosso spessore
Per applicazioni meccaniche

| Diametro mm | Spessore | | | | | | | | | | |
|----------------|----------|------|------|------|------|-------|------|------|------|-----|-----|
| | 8 | 10 | 12,5 | 14,2 | 16 | 17,5 | 20 | 25 | 30 | 35 | 40 |
| 48,3 | 7,93 | 9,45 | | | | | | | | | |
| 51 | 8,43 | 10,1 | 11,9 | | | | | | | | |
| 54 | 9,04 | 10,9 | 12,9 | | | | | | | | |
| 57 | 9,65 | 11,6 | 13,8 | | | | | | | | |
| 60,3 | 10,3 | 12,4 | 14,8 | | | | | | | | |
| 63,5 | 10,9 | 13,2 | 15,8 | | | | | | | | |
| 67 | 11,6 | 14,1 | 16,3 | 18,3 | 20,1 | | | | | | |
| 70 | 12,2 | 14,8 | 17,8 | 19,3 | 21,2 | | | | | | |
| 76,1 | 13,4 | 16,3 | 19,7 | 21,4 | 23,7 | | | | | | |
| 82,5 | 14,6 | 17,9 | 21,7 | 23,8 | 26,2 | 28,8 | 30,8 | | | | |
| 88,9 | 15,9 | 19,5 | 23,7 | 25,9 | 28,7 | 31,5 | 34,0 | | | | |
| 95 | 17,2 | 21,0 | 24,6 | 28,0 | 31,2 | 34,2 | 37,0 | | | | |
| 101,6 | 18,4 | 22,6 | 27,6 | 30,4 | 33,7 | 37,3 | 40,2 | 47,5 | | | |
| 108 | 19,6 | 24,2 | 29,6 | 32,5 | 36,2 | 40,4 | 43,4 | 51,4 | | | |
| 114,3 | 20,9 | 25,7 | 31,6 | 34,3 | 38,6 | 42,6 | 46,5 | 55,3 | | | |
| 121 | 21,3 | 27,4 | 32,3 | 36,9 | 41,4 | 45,7 | 49,8 | 60,1 | 67,3 | | |
| 127 | 23,4 | 28,9 | 35,5 | 39,0 | 43,6 | 48,4 | 52,8 | 63,2 | 71,8 | | |
| 133 | 24,6 | 30,3 | 37,4 | 41,4 | 46,1 | 51,0 | 55,7 | 67,1 | 76,2 | | |
| 139,7 | 25,9 | 32,0 | 39,5 | 43,5 | 48,6 | 54,2 | 59,0 | 71,1 | 81,2 | | |
| 146 | 27,2 | 33,5 | 39,7 | 45,6 | 51,3 | 56,8 | 62,2 | 74,8 | 85,2 | | |
| 152,4 | 28,4 | 35,1 | 43,4 | 47,6 | 53,6 | 59,5 | 65,3 | 79,0 | 90,6 | | |
| 159 | 28,4 | 36,7 | 45,4 | 50,1 | 56,2 | 62,6 | 68,6 | 83,0 | 95,4 | | |
| 168,3 | | 39,0 | 48,4 | 53,5 | 59,9 | 66,5 | 73,1 | 89,9 | 102 | | |
| 177,8 | | 41,4 | 51,3 | 56,6 | 63,6 | 71,0 | 77,8 | 94,8 | 109 | | |
| 193,7 | | 45,3 | 56,2 | 62,0 | 69,8 | 78,0 | 85,7 | 105 | 121 | | |
| 203 | | 47,5 | 58,5 | 65,3 | 73,8 | 82,1 | 90,3 | 110 | 128 | | |
| 219,1 | | | 64,1 | 71,0 | 79,8 | 89,0 | 98,2 | 120 | 140 | 159 | 177 |
| 229 | | | 66,5 | 74,2 | 84,0 | 93,7 | 103 | 126 | 147 | 167 | 186 |
| 244,5 | | | 72,0 | 80,0 | 89,8 | 103,5 | 111 | 136 | 151 | 181 | 202 |
| 254 | | | 75,0 | 82,9 | 93,9 | 105 | 115 | 141 | 166 | 189 | 211 |
| 273 | | | 80,9 | 89,5 | 101 | 113 | 125 | 154 | 180 | 205 | 230 |
| 298,5 | | | 88,8 | 98,5 | 111 | 124 | 137 | 170 | 199 | 227 | 255 |
| 305 | | | 90,2 | 100 | 113 | 127 | 141 | 173 | 203 | 233 | 261 |
| 323,9 | | | 96,7 | 107 | 121 | 135 | 150 | 186 | 217 | 249 | 280 |
| 330 | | | | 109 | 124 | 138 | 153 | 189 | 222 | 255 | 286 |
| 343 | | | | 114 | 129 | 144 | 159 | 197 | 232 | 266 | 299 |
| 355,6 | | | | 118 | 134 | 150 | 166 | 205 | 241 | 277 | 312 |
| 368 | | | | 122 | 139 | 155 | 172 | 213 | 250 | 287 | 324 |
| 381 | | | | 127 | 144 | 161 | 178 | 221 | 260 | 299 | 366 |
| 394 | | | | 131 | 149 | 167 | 184 | 229 | 269 | 310 | 349 |
| 406,4 | | | | 135 | 154 | 172 | 190 | 237 | 278 | 320 | 361 |
| 419 | | | | 140 | 159 | 178 | 197 | 245 | 288 | 331 | 374 |

TUBI

saldati triangolari

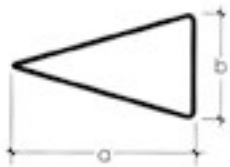

| Dimensioni axb mm | Spessore mm | Peso Kg/ml |
|----------------------|-------------|------------|
| 30x15 | 1,5 | 0,87 |
| 40x22 | 1,5 | 1,24 |

TUBI

saldati ovali

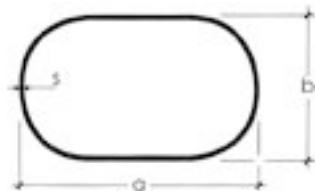

| Dimensioni axb mm | Spessore mm | Peso Kg/ml |
|----------------------|-------------|------------|
| 30x15 | 1,5 | 0,87 |
| 40x20 | 1,5 | 1,12 |
| 50x10 | 1,5 | 1,25 |
| 50x25 | 1,5 | 1,54 |
| 60x30 | 1,5 | 2,12 |

TUBI

saldati semiovali



| Dimensioni axb mm | Spessore mm | Peso Kg/ml |
|----------------------|-------------|------------|
| 40x20 | 1,5 | 1,11 |
| 40x25 | 1,5 | 1,22 |

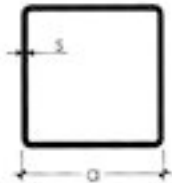

TUBI

saldati quadri da nastro laminati a caldo

| a mm | Spessore | | | | | | | |
|---------|----------|------|-------|-------|-------|-------|-------|-------|
| | 1,5 | 2 | 3 | 4 | 5 | 6 | 8 | 10 |
| 10x10 | 0,34 | | | | | | | |
| 12x12 | 0,43 | | | | | | | |
| 15x15 | 0,57 | 0,70 | | | | | | |
| 20x20 | 0,81 | 1,02 | 1,36 | | | | | |
| 25x25 | 1,05 | 1,34 | 1,83 | | | | | |
| 30x30 | 1,28 | 1,65 | 2,30 | 2,84 | | | | |
| 35x35 | 1,52 | 1,96 | 2,77 | 3,46 | | | | |
| 40x40 | 1,75 | 2,28 | 3,24 | 4,09 | 4,83 | | | |
| 45x45 | 1,99 | 2,60 | 3,71 | 4,72 | 5,61 | | | |
| 50x50 | 2,22 | 2,91 | 4,19 | 5,35 | 6,40 | | | |
| 55x55 | | | 4,52 | | | | | |
| 60x60 | 2,69 | 3,54 | 5,13 | 6,51 | 7,97 | 10,15 | | |
| 65x65 | 2,93 | 3,85 | 5,60 | 7,24 | 8,75 | 10,34 | | |
| 70x70 | | 4,16 | 6,07 | 7,86 | 9,54 | 11,10 | | |
| 80x80 | | 4,79 | 7,02 | 9,12 | 11,11 | 12,99 | 16,38 | |
| 90x90 | | 5,42 | 7,96 | 10,38 | 12,68 | 14,87 | 18,89 | |
| 100x100 | | 6,07 | 8,90 | 11,64 | 14,26 | 16,76 | 21,41 | 24,89 |
| 110x110 | | | 9,84 | 12,89 | 15,83 | 18,64 | 23,93 | 28,03 |
| 120x120 | | | 10,79 | 14,15 | 17,40 | 20,53 | 26,44 | 31,17 |
| 140x140 | | | 12,72 | 16,76 | 20,52 | 24,28 | 31,43 | 37,45 |
| 150x150 | | | 13,62 | 17,92 | 22,11 | 26,19 | 33,98 | 40,59 |
| 160x160 | | | 14,61 | 19,27 | 23,66 | 28,04 | 34,46 | 43,73 |
| 175x175 | | | 15,98 | 21,07 | 26,04 | 30,90 | 40,27 | 48,44 |
| 200x200 | | | 17,19 | 24,29 | 29,94 | 35,58 | 46,51 | 56,29 |
| 220x220 | | | | 26,73 | 33,12 | 39,39 | 51,59 | 62,57 |
| 250x250 | | | | 30,57 | 37,79 | 45,00 | 59,07 | 71,99 |
| 260x260 | | | | 31,76 | 39,41 | 46,94 | 61,61 | 75,13 |
| 300x300 | | | | | 45,64 | 54,42 | 71,63 | 87,69 |



TUBI

saldati rettangolari da nastro laminati a caldo

| a x b mm | Spessore | | | | |
|-------------|----------|------|------|------|------|
| | 1,5 | 2 | 2,5 | 3 | 4 |
| 15x10 | 0,52 | | | | |
| 20x10 | 0,64 | 0,81 | | | |
| 20x15 | 0,75 | 0,97 | | | |
| 25x10 | 0,75 | 0,97 | | | |
| 25x15 | 0,87 | 1,13 | | | |
| 30x10 | 0,87 | 1,13 | | | |
| 30x15 | 0,99 | 1,29 | 1,44 | 1,65 | |
| 30x20 | 1,11 | 1,44 | 1,77 | 2,07 | |
| 30x25 | 1,22 | 1,60 | 1,96 | 2,31 | |
| 35x10 | 0,99 | 1,29 | | | |
| 35x15 | 1,11 | 1,44 | 1,77 | 2,07 | |
| 35x20 | 1,22 | 1,60 | 1,96 | 2,31 | |
| 35x25 | 1,34 | 1,76 | 2,16 | 2,54 | |
| 40x10 | 1,11 | 1,44 | | | |
| 40x15 | 1,22 | 1,60 | 1,84 | 2,13 | |
| 40x20 | 1,34 | 1,76 | 2,16 | 2,54 | |
| 40x25 | 1,46 | 1,91 | 2,34 | 2,78 | |
| 40x30 | 1,58 | 2,07 | 2,55 | 3,01 | 3,83 |
| 45x10 | 1,22 | 1,52 | | | |
| 45x15 | 1,34 | 1,76 | | | |
| 45x20 | 1,46 | 1,91 | 2,23 | 2,78 | |
| 45x25 | 1,58 | 2,07 | 2,42 | 3,01 | |
| 50x10 | 1,34 | 1,76 | | | |
| 50x15 | 1,46 | 1,92 | | | |



TUBI

saldati rettangolari da nastro laminati a caldo

| a x b mm | Spessore | | | | | | | |
|-------------|----------|------|-------|-------|-------|-------|-------|-------|
| | 1,5 | 2 | 3 | 4 | 5 | 6 | 8 | 10 |
| 50x20 | 1,58 | 2,07 | 3,01 | | | | | |
| 50x25 | 1,77 | 2,23 | 3,25 | | | | | |
| 50x30 | 1,81 | 2,39 | 3,49 | 4,52 | | | | |
| 50x40 | 2,05 | 2,70 | 3,96 | 5,15 | | | | |
| 60x10 | 1,58 | 2,07 | | | | | | |
| 60x15 | 1,77 | 2,23 | | | | | | |
| 60x20 | 1,81 | 2,39 | 3,30 | | | | | |
| 60x25 | 1,87 | 2,43 | 3,58 | | | | | |
| 60x30 | 1,99 | 2,59 | 3,71 | 4,72 | | | | |
| 60x40 | 2,22 | 2,91 | 4,19 | 5,35 | 6,39 | | | |
| 60x50 | 2,46 | 3,22 | 4,66 | 5,98 | 8,02 | | | |
| 70x20 | 1,99 | 2,59 | 3,71 | | | | | |
| 70x25 | 2,10 | 2,75 | 3,95 | | | | | |
| 70x30 | 2,22 | 2,91 | 4,19 | 5,35 | | | | |
| 70x40 | 2,46 | 3,22 | 4,66 | 5,98 | 7,59 | | | |
| 70x50 | 2,69 | 3,53 | 5,13 | 6,61 | 7,97 | 9,21 | | |
| 80x15 | 2,10 | 2,75 | | | | | | |
| 80x20 | 2,22 | 2,91 | 4,19 | | | | | |
| 80x25 | 2,34 | 3,06 | 4,42 | | | | | |
| 80x30 | 2,46 | 3,33 | 4,56 | 5,98 | | | | |
| 80x40 | 2,69 | 3,53 | 5,40 | 6,60 | 7,96 | 9,21 | | |
| 80x50 | 2,93 | 3,85 | 5,60 | 7,24 | | | | |
| 80x60 | | 4,16 | 6,07 | 7,86 | 9,54 | 11,10 | | |
| 90x30 | | 3,56 | 5,19 | 6,71 | | | | |
| 90x40 | | 3,85 | 5,60 | 7,24 | | | | |
| 90x50 | | 4,16 | 6,07 | 7,86 | | | | |
| 90x60 | | 4,48 | 6,54 | 8,49 | | | | |
| 100x20 | | 3,57 | 6,13 | | | | | |
| 100x30 | | 3,85 | 5,60 | 7,24 | | | | |
| 100x40 | | 4,16 | 6,07 | 7,86 | 9,54 | 11,10 | 13,86 | |
| 100x50 | | 4,48 | 6,54 | 8,49 | 10,32 | 12,04 | 15,12 | |
| 100x60 | | 4,79 | 7,02 | 9,11 | 11,10 | 12,98 | 16,38 | |
| 100x80 | | 5,42 | 7,96 | 10,38 | 12,58 | 14,87 | | |
| 110x50 | | 4,79 | 7,02 | 9,12 | 11,11 | 12,98 | | |
| 120x30 | | 4,50 | 6,60 | 8,59 | | | | |
| 120x40 | | 4,52 | 7,02 | 9,12 | 11,11 | 12,98 | 16,38 | |
| 120x50 | | 4,80 | 7,23 | 9,64 | | | | |
| 120x60 | | 5,41 | 7,96 | 10,37 | 12,67 | 14,37 | 18,89 | |
| 120x80 | | 6,05 | 8,90 | 11,63 | 14,24 | 16,76 | 21,41 | |
| 130x50 | | 5,42 | 7,96 | 10,38 | 12,68 | 14,87 | | |
| 140x40 | | | 7,66 | 10,22 | 12,70 | | | |
| 140x60 | | 6,05 | 8,90 | 11,64 | 14,25 | 16,76 | 21,41 | |
| 140x70 | | 6,36 | 9,37 | 12,27 | 15,04 | 17,70 | | |
| 140x80 | | 6,68 | 9,84 | 12,89 | 15,83 | 18,64 | | |
| 150x30 | | 5,52 | 8,19 | | | | | |
| 150x40 | | 5,90 | 8,80 | 10,81 | 13,43 | | | |
| 150x50 | | 6,05 | 8,90 | 11,64 | 14,25 | 16,76 | 21,41 | |
| 150x60 | | | | 12,97 | | | | |
| 150x100 | | | 11,26 | 14,77 | 18,17 | 21,47 | 27,67 | 32,80 |
| 160x60 | | | 10,06 | 13,32 | 16,53 | 19,69 | | |
| 160x80 | | | 10,79 | 14,14 | 17,38 | 20,53 | 26,41 | |
| 180x60 | | | 10,79 | 14,15 | 17,40 | 20,53 | 26,44 | |
| 180x80 | | | 11,73 | 15,41 | 18,97 | 22,42 | 28,95 | |
| 200x100 | | | 13,62 | 17,91 | 22,09 | 26,19 | 33,95 | 41,59 |
| 200x150 | | | 16,02 | 21,15 | 26,02 | 30,87 | 40,23 | 48,44 |
| 250x100 | | | 15,98 | 21,07 | 26,04 | 30,90 | 40,27 | 48,44 |

Tubolari per serramenti

spessore mm 1,5 - neri, decapati e zincati

1A kg/m 1,72

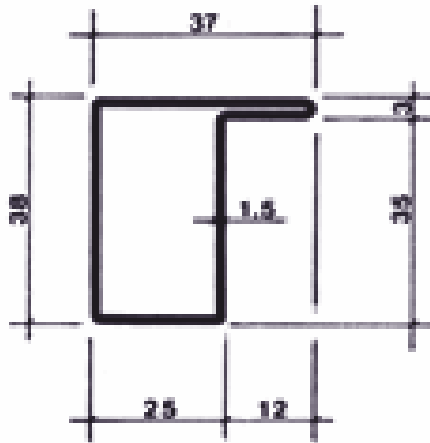

11A kg/m 1,34

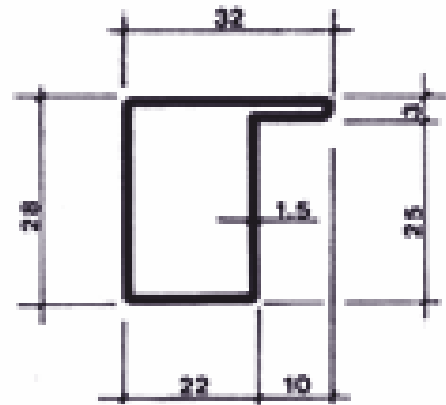

1B kg/m 2,10

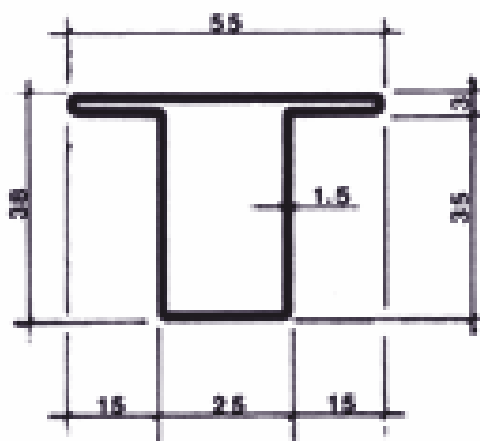

11B kg/m 1,57

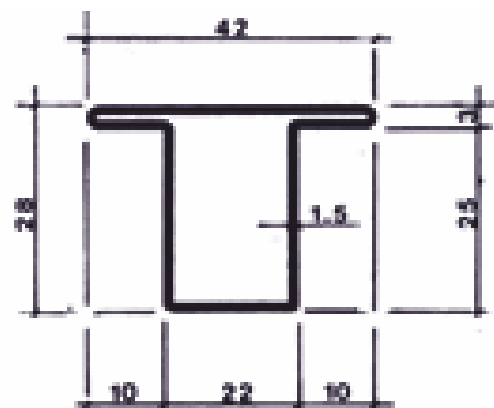

1C kg/m 1,99

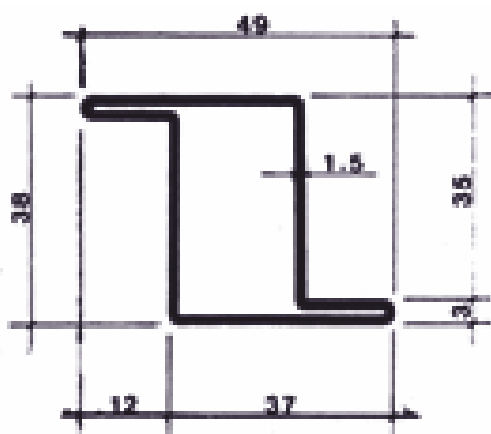

11C kg/m 1,57

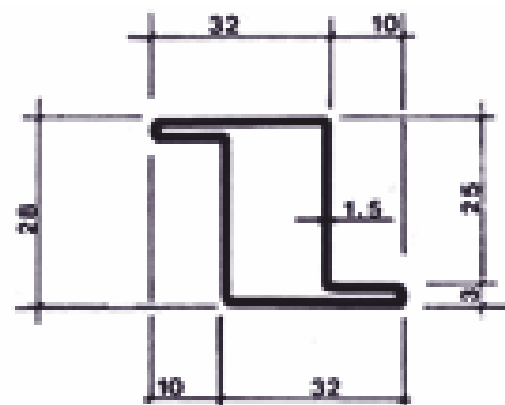

Tubolari per serramenti

spessore mm 1,5 - neri, decapati e zincati

2A kg/m 1,76

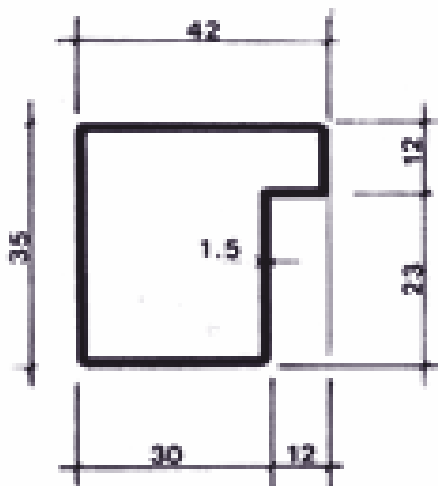

2N kg/m 2,30

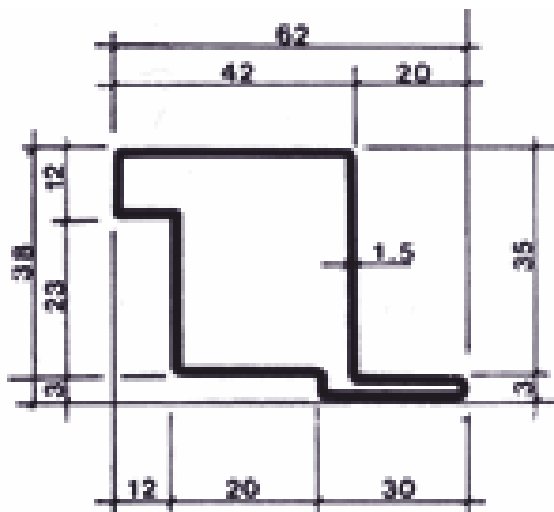

2B kg/m 1,88

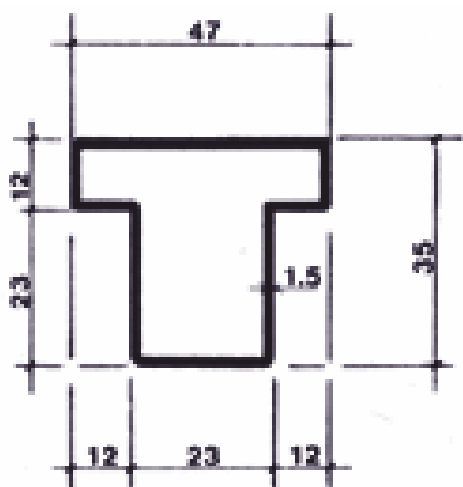

2T kg/m 2,30

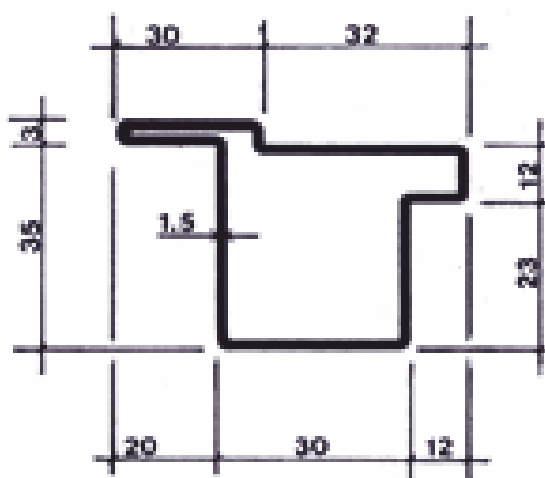

2Z kg/m 1,88

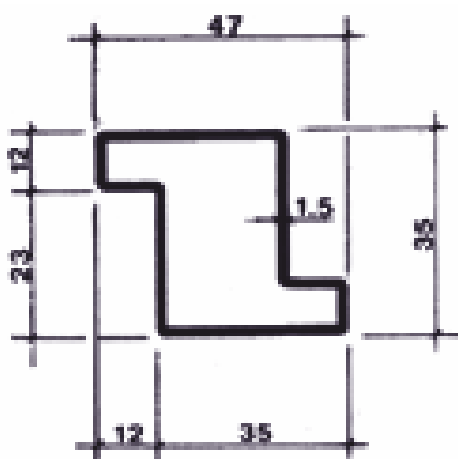

Tubolari per serramenti

spessore mm 1,5 - neri, decapati e zincati

15A kg/m 2,04

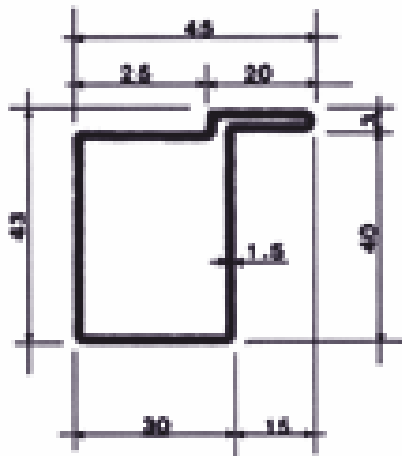

15B kg/m 2,72

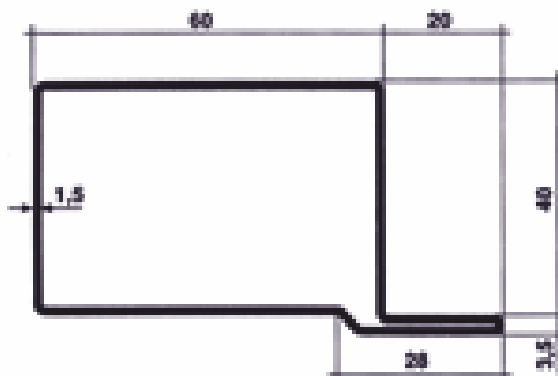

15T kg/m 2,45

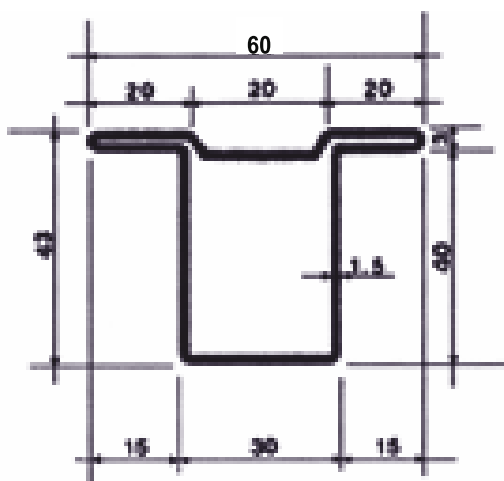

10B kg/m 1,40

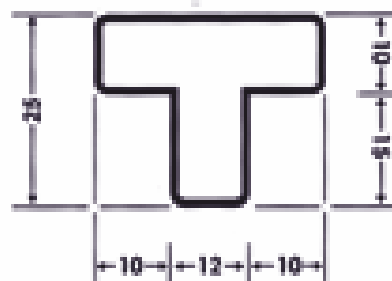

15Z kg/m 2,45

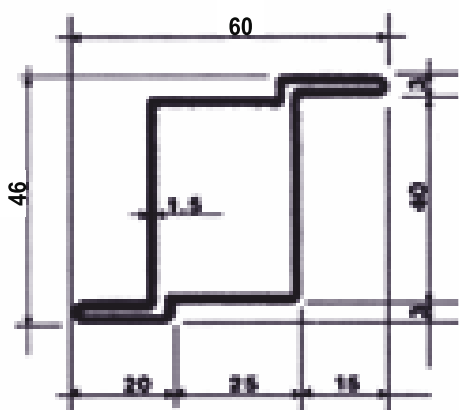

10A kg/m 1,40

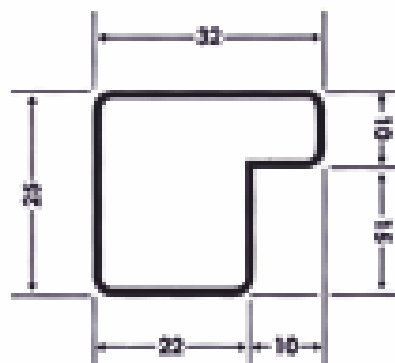

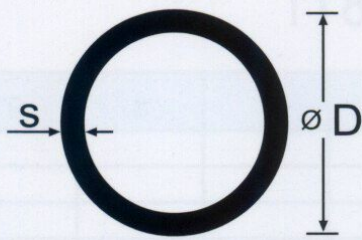

TUBI SALDATI PER CARPENTERIA

| DN | Ø D | S * | kg / m |
|---------|-------|------|--------|
| 3 / 8" | 16,75 | 1,8 | 0,66 |
| 1 / 2" | 21,25 | 2,2 | 1,03 |
| 3 / 4" | 26,75 | 2,5 | 1,50 |
| 1" | 33,5 | 2,65 | 2,02 |
| 1 1/4 " | 42,4 | 3 | 2,91 |
| 1 1/2 " | 48,3 | 3 | 3,35 |
| 2" | 60,3 | 3 | 4,24 |
| 2 1/2 " | 76,1 | 3 | 5,41 |
| 3" | 88,9 | 3 | 6,36 |
| 3 1/2 " | 101,6 | 3 | 7,29 |
| 4" | 114,3 | 3 | 8,23 |
| 4 1/2 " | 127 | 3,7 | 11,26 |
| 5" | 139,7 | 3,7 | 12,41 |
| 5 1/2 " | 152 | 4 | 14,61 |
| 6" | 168 | 4 | 16,18 |
| 7 1/2 " | 193,7 | 4 | 18,65 |
| 8" | 219 | 5 | 26,40 |

* spessore per impieghi più correnti.
I tubi possono tuttavia essere forniti anche
con spessore diverso.

Tubolari per portoni

spessore mm 1,5 - Neri e Zincati

MT5 - 15/10=kg/ml 1,65

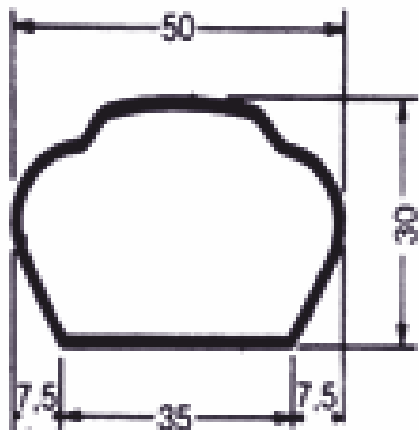

MT6 - 15/10=kg/ml 2,15

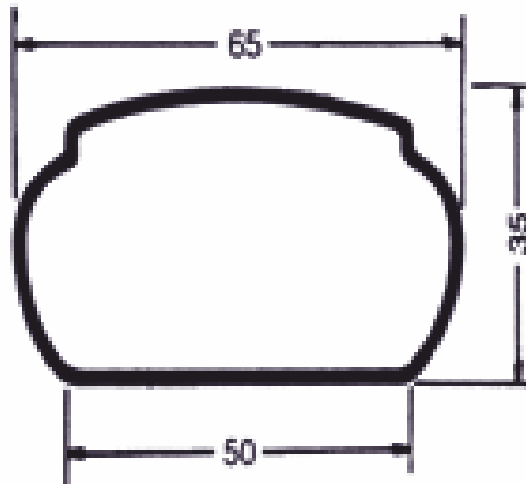

MT7 - 15/10=kg/ml 2,15

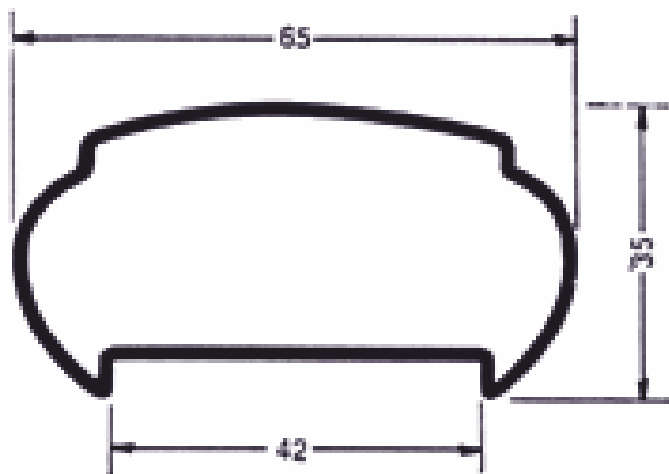

MT8 - 15/10=kg/ml 1,87

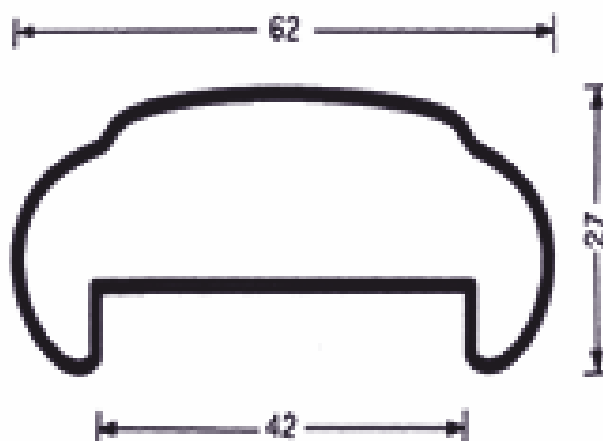

MT9 - 15/10=kg/ml 1,60

